



Recreation Light System - LED

| | |
|----------------|------|
| Catalog Number | |
| Project | Type |

FEATURES & SPECIFICATIONS

APPLICATION – The SportPole Series is designed to be used in any application where multiple or singular sports activities are being played and simultaneously require a premium lighting system. The 16' two (2) piece sportpole is optimal for the avid sport enthusiast who requires the ability to "hit the court" at any time, day or night! This poles' versatile sports court applications include; Pickleball, Tennis, Badminton, and Volleyball, which makes this series a perfect fit for the avid sportsperson or host! The sportpole comes standard with our Ultra High Lumen Output Scimitar LED Light, (2 Module Unit) emitting 23,000-45,000 nominal lumens (per fixture) in Cool White color temperature. Comes standard with T4 and T5M optics. Additional optics may be available upon request, consult your sales rep for options or alternate luminaire types that might be available.

CONSTRUCTION –

Pole Top: Fabricated from hot rolled carbon steel having a minimum yield of 55,000 PSI and conforms to ASTM A-500 grade C requirements. This section can be combined with the bottom pole section and used to light most homes or small recreational centers. This sectional pole's size makes installation and maintenance easy for anyone without having to rent large specialty equipment.

Pole Bottom: Also composed of carbon steel and finished with a polyester thermosetting powder coat, it will stand up to the toughest weather conditions in your area. Supplied with a pivot anchor base plus bolts, each bottom pole is also drilled for the sporting applications mentioned above. For additional safety, the pivotal anchor



base is supplied with two (2) locks to prevent unwarranted tampering and removal of those pivot bolts.

ANCHORAGE – A set of four (4) fully galvanized 3/4" x 18" x 3" anchor bolts are provided standard. Each bolt comes with two (2) galvanized hex nuts and flat washers.

MOUNTING – The pole comes standard with a 2 3/8" OD tenon to accommodate single or double fixture mounting hardware. Fixtures mounted to this tenon can be adjusted vertically as well as left to right. Standard mounting option is a (2AF) 2" Adjustable Slip Fitter. Additional mounting options are available for custom applications.

FINISH – A Super Durable Polyester powder coat finish is applied electrostatically in our state of the art paint facility. Standard colors available: Black, Bronze, US Green, White. Custom colors available upon request.

ORDERING INFORMATION

Choose the bold face options for the appropriate luminaire configuration for your application and enter on the line above each fixture attribute. Accessories may be factory installed, depending on the particular accessory chosen, but still be ordered as a separate line item.

| SPORT | | | | | |
|--------|----------------------------|-------------------------|--------------------------|----------------------------------|--------------------------------|
| SERIES | # OF FIXTURES ¹ | OPTICS | NOMINAL LUMENS | VOLTAGE | FINISH |
| | 1 Single Fixture : | T5M TypeV Medium | 23L (Per Fixture) | 1 Multi-Volt ² | BK Black |
| | 2-3/8" OD Tenon | T4 Type IV | 25L (Per Fixture) | 2 347-480 | BZ Bronze |
| | (T238) | | 28L (Per Fixture) | | GR US Green |
| | 2 Double Fixtures : | | 30L (Per Fixture) | | WH White |
| | (TV2) | | 33L (Per Fixture) | | SP Special ³ |
| | | | 35L (Per Fixture) | | |
| | | | 38L (Per Fixture) | | |
| | | | 40L (Per Fixture) | | |
| | | | 43L (Per Fixture) | | |
| | | | 45L (Per Fixture) | | |

EXAMPLE:

SPORT 2 T4 45L 1 BK

ACCESSORIES (Order as separate line items)

| | |
|-------------------------|--|
| PC2 | 480V Twist-Lock Photocell |
| PC7 | Multi-Tap (105-285V) Twist-Lock Photocell |
| S213⁴ | Angled Black Light Shield |
| NET WINCH | Sport Pole Net Winch (Cable Not Included) |
| TLGFIA | Ground Fault Receptacle |
| PHH | Additional Hand Hole |
| KAB3418G125 | AB Kit (4) 3/4" x 18" Galv. Bolts and Rigid Template |

NOTES

- ¹ = OD Tennon comes standard with both options.
- ² = Multi-Volt is an auto ranging power supply from 100V to 300V input.
- ³ = Custom RAL color matching is available. Contact your sales representative for additional information.
- ⁴ = Order one per LED module. Field installed.

| FIXTURE WEIGHTS (APPROX) | |
|--------------------------|-----------------|
| Fixture Configuration | 2 Module |
| Weight (lbs) | 23 lbs |



2AF (Standard)
2" Adjustable Slip Fitter

TV2 (2-3/8" OD)
2 Tennon Square Straight Bull Horn

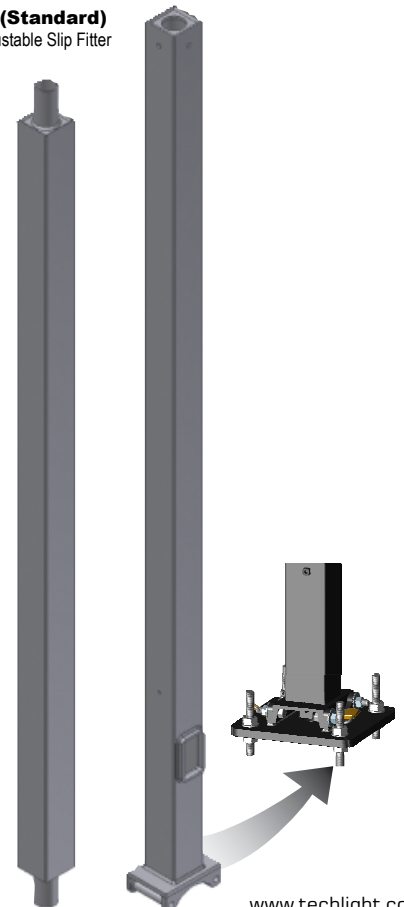

SPORT POLE SERIES Recreation Light System - LED

DIMENSIONS

2 Module

SportPole (16')

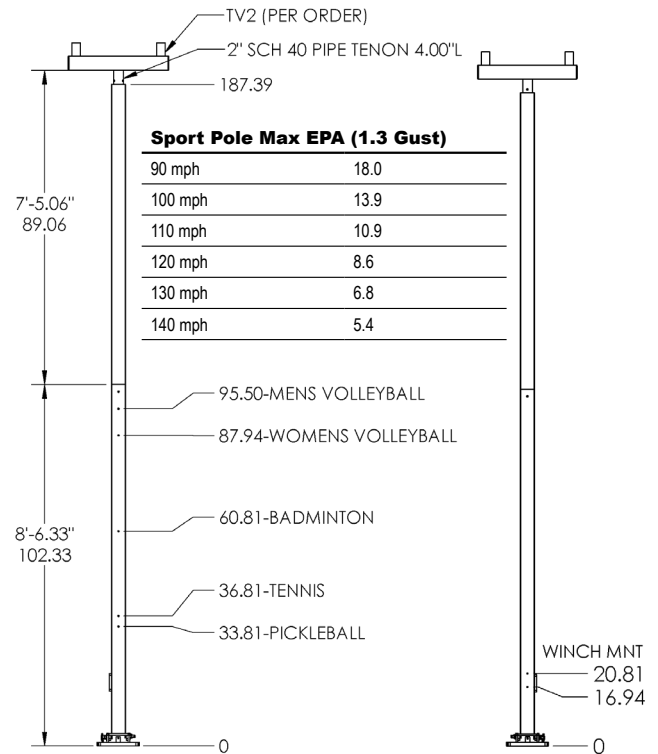
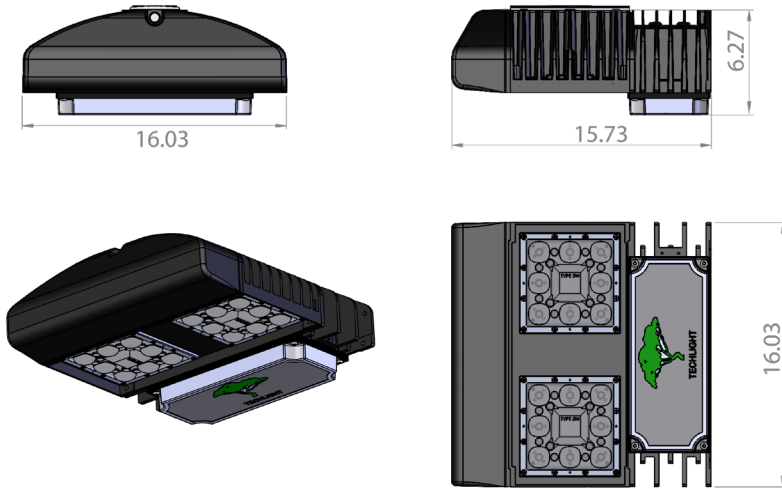

PHOTOMETRICS

IES INDOOR REPORT
PHOTOMETRIC
FILE NAME: (1)
LSMA2C45LT5M

(1) Type V Medium Optical
Assembly
2 Module, Cool White

LSMA LED Scimitar Flood
Color Temperature: 5,000 K

| FIXTURE WEIGHTS (APPROX) | |
|--------------------------|----------|
| Fixture Configuration | 2 Module |
| Weight (lbs) | 23 lbs |

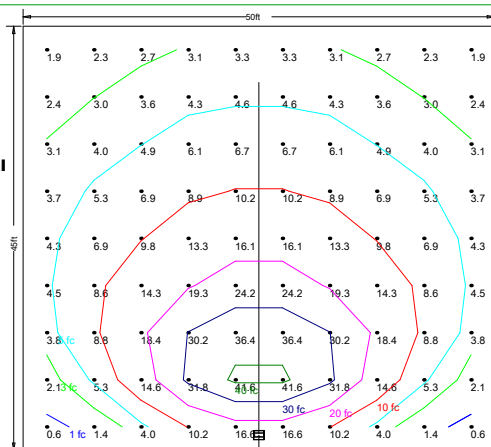

Bolt Circle
(Always measured on the diagonal)

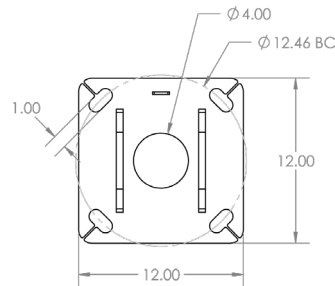

LUMEN CHART

| | T5M | T4 |
|-----|-----------------|-----------------|
| 23L | 23,805 Lm | 23,364 Lm |
| | 147W 162 Lm/W | 147W 159 Lm/W |
| 25L | 25,275 Lm | 24,806 Lm |
| | 157W 161 Lm/W | 157W 158 Lm/W |
| 28L | 27,458 Lm | 27,658 Lm |
| | 173W 159 Lm/W | 179W 155 Lm/W |
| 30L | 30,331 Lm | 29,769 Lm |
| | 195W 156 Lm/W | 195W 153 Lm/W |
| 33L | 32,456 Lm | 32,544 Lm |
| | 211W 154 Lm/W | 217W 150 Lm/W |
| 35L | 35,250 Lm | 35,275 Lm |
| | 233W 151 Lm/W | 238W 148 Lm/W |
| 38L | 37,316 Lm | 37,962 Lm |
| | 249W 150 Lm/W | 260W 146 Lm/W |
| 40L | 40,031 Lm | 39,949 Lm |
| | 271W 148 Lm/W | 277W 144 Lm/W |
| 43L | 42,702 Lm | 42,560 Lm |
| | 293W 146 Lm/W | 299W 142 Lm/W |
| 45L | 45,329 Lm | 45,126 Lm |
| | 316W 143 Lm/W | 321W 141 Lm/W |

AMPERAGE DRAW

| Wattage Range | 120V Amps | 208V Amps | 240V Amps | 277V Amps | 347V Amps | 480V Amps |
|---------------|-----------|-----------|-----------|-----------|-----------|-----------|
| 101-150W | 1.3 | 0.7 | 0.6 | 0.5 | 0.4 | 0.3 |
| 151-200W | 1.7 | 1 | 0.8 | 0.7 | 0.6 | 0.4 |
| 201-250W | 2.1 | 1.2 | 1 | 0.9 | 0.7 | 0.5 |
| 251-300W | 2.5 | 1.4 | 1.3 | 1.1 | 0.9 | 0.6 |
| 301-350W | 2.9 | 1.7 | 1.5 | 1.3 | 1 | 0.7 |

EPA RATINGS (ft²)

EPA's shown below include both the fixture and the mounting apparatus.

LSMA 2 (Two Module)

| | DESCRIPTION | 0° | 20° | 30° | 45° | 60° | 70° | 90° |
|------|-----------------------|-----|-----|-----|-----|-----|-----|-----|
| TV2 | Two In-Line Tenons | 2.2 | 3.0 | 3.4 | 3.9 | 4.2 | 4.4 | 5.1 |
| T238 | Single Vertical Tenon | 0.7 | 1.0 | 1.3 | 1.5 | 1.7 | 1.8 | 2.1 |

WARNING: Maintenance performed including the replacement of LED bricks while power is still supplied to the luminaire may result in system failures and will void the warranty



2707 SATSUMA | DR. DALLAS, TX 75229 | PH: 800.225.0727 | www.techlight.com

All dimensions and specifications are subject to change without notice.

REV: 20240116-03